

Obsolescence: Secure machine availability

Line improvement: OCE007 layer compacting device gearboxes WA replacement

Sidel Service Engineering – Line Improvement, Modernization

Service package: all you can need!



MAINTENANCE



LINE
IMPROVEMENT



TRAINING



SPARE PARTS
& LOGISTICS



LINE CONVERSIONS
& MOULDS



PACKAGING



Line improvement

Time to increase your resource efficiency



The full package

- Options
- Upgrades
- Remote data analysis
- Line audits
- Second-hand equipment

Sidel Options & Upgrades

Made for you and your line

OPTIONS & UPGRADES

- Boost product quality
- Increase efficiency
- Reduce Total Cost of Ownership (TCO)
- Future-proof your productivity



Anticipate Spare parts shortage

Kit to replace Gearboxes WA47 with KA39 on layer compacting device

Value and benefit

- Safer solution with newer component available in the market.
- Can prevent long downtimes in case of failure
- SEW gearboxes WA37 are phased out by manufacturer.
- Spare Part unavailability.
- Risk of long Downtime for equipment at Bottlers prod plants as it takes an upgrade to be able to install active newer components.

Description

- New system with gearboxes SEW KA39:
 - The new system consists of gearboxes KA39: with similar reduction ratio, replacing the obsolete ones.
 - Available in case of brushless and asynchronous motors
 - It includes adaptation kit

Technical description: Main principles

Kit to instal gearboxes Gearbox KA39 on layer compacting device

Parts involved

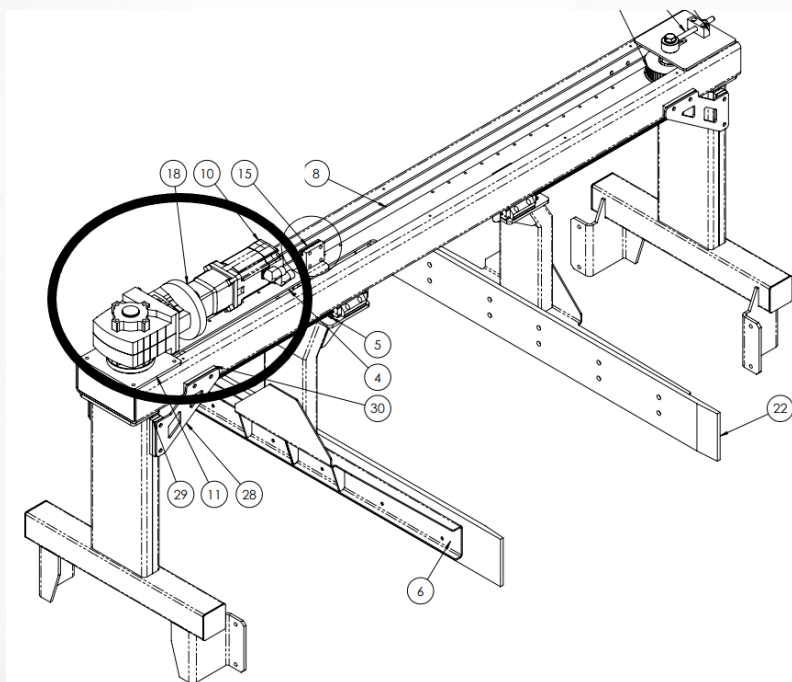

Replacement kit

Kit Brushless

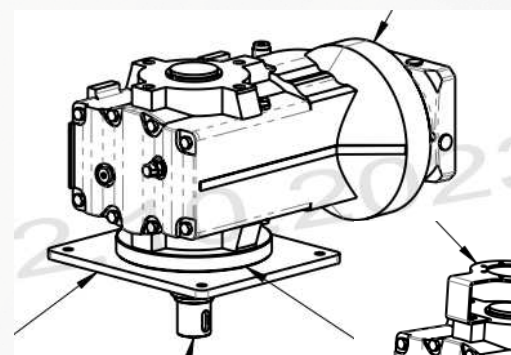

Kit asynchronous

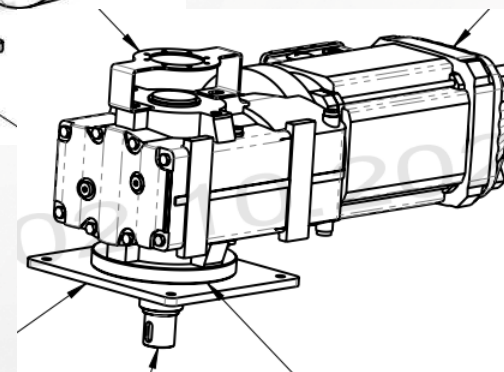

New solution:

- The solution is installed in place of the existing one;
- Sustainable and Available components.
- Motors can be recovered only if brushless

Technical overview:

TECHNICAL OVERVIEW	
O&U Theme	Obsolescence
Ease of implementation	1/3 (Easy)
Machine application exclusion?	No
Mandatory option needed?	No
Targeted sub-assembly	Layer compacting device
Diagnostic visit and/or equipment refurbishment needed before upgrade?	No
Time to install upgrade (Line Downtime)	1 days
Sidel expertise needed on site?	Yes: 1,5 x Sidel Mech L5 + 1,5 x Sidel Auto L5 = Tot 3 MDs
Sidel production supervision at restart / Recommissioning needed?	No
Average delivery time	10 weeks

All market segments, always first served!



***Technicians levels**

Level 1	<i>Generic operator</i>
Level 2	<i>Mechanical/electrical maintenance technician</i>
Level 3	<i>Customer maintenance supervisor</i>
Level 5	<i>Sidel Engineer</i>
RPS/GPS	<i>Product Support</i>